

FI-22442

DD Motor

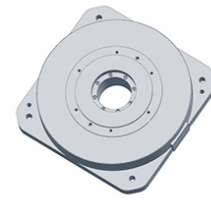

MAIN PARAMETERS	VALUE
Voltage(VAC)	220
Rated torque (Nm)	9.9
Instant Max Torque (Nm)	30
Torque constant (Nm/Arms)	4.3
Rated Current (Arms)	2.3
Instant Max Current (Arms)	7
Resistance (Ω)	22.5
Inductance (mH)	50.4
Pole-pairs number (2P)	20
Back EMF coefficient (Vrms/rad/s)	3.5
Rated Output (W)	155.6
Rotor inertia 10^{-4} kg.m ²	72
Rated Speed (rpm)	150
Max Speed (rpm)	250
Positioning accuracy(arc_sec)	± 20
Repeat positioning accuracy (arc_sec)	± 1.5
Encoder resolution (sin/cos)	11740
Axial load (N)	2500
Radial load (N.m)	50
Axial runout (mm)	≤ 0.005
Radial runout (mm)	≤ 0.005
Weight (kg)	6.3

Specification & drawing

