

# FE-22462

## DD Motor(External Rotor)

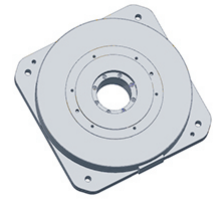

| MAIN PARAMETERS                       | VALUE        |
|---------------------------------------|--------------|
| Voltage(VAC)                          | 220          |
| Rated torque (Nm)                     | 35.0         |
| Instant Max Torque (Nm)               | 105          |
| Torque constant (Nm/Arms)             | 15.7         |
| Rated Current (Arms)                  | 2.2          |
| Instant Max Current (Arms)            | 6.6          |
| Resistance ( $\Omega$ )               | 13.8         |
| Inductance (mH)                       | 40           |
| Pole-pairs number (2P)                | 20           |
| Back EMF coefficient (Vrms/rad/s)     | 12.8         |
| Rated Output (W)                      | 366.8        |
| Rotor inertia $10^{-4}kg.m^2$         | 300          |
| Rated Speed (rpm)                     | 100          |
| Max Speed (rpm)                       | 200          |
| Positioning accuracy(arc_sec)         | $\pm 20$     |
| Repeat positioning accuracy (arc_sec) | $\pm 1.5$    |
| Encoder resolution (sin/cos)          | 16384        |
| Axial load (N)                        | 10000        |
| Radial load (N.m)                     | 120          |
| Axialrunout (mm)                      | $\leq 0.005$ |
| Radial runout (mm)                    | $\leq 0.005$ |
| Weight (kg)                           | 9.2          |

### Specification & drawing

