

FE-22442

DD Motor(External Rotor)

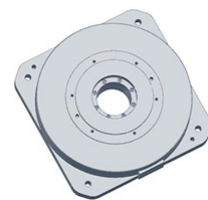

MAIN PARAMETERS	VALUE
Voltage(VAC)	220
Rated torque (Nm)	14.1
Instant Max Torque (Nm)	42.2
Torque constant (Nm/Arms)	6.4
Rated Current (Arms)	2.2
Instant Max Current (Arms)	6.6
Resistance (Ω)	7.5
Inductance (mH)	17.1
Pole-pairs number (2P)	20
Back EMF coefficient (Vrms/rad/s)	5.2
Rated Output (W)	295.5
Rotor inertia $10^{-4}kg.m^2$	120
Rated Speed (rpm)	200
Max Speed (rpm)	380
Positioning accuracy(arc_sec)	± 20
Repeat positioning accuracy (arc_sec)	± 1.5
Encoder resolution (sin/cos)	11740
Axial load (N)	10000
Radial load (N.m)	120
Axialrunout (mm)	≤ 0.005
Radial runout (mm)	≤ 0.005
Weight (kg)	5.5

Specification & drawing

