

FE-224 series DD Motor(External Rotor)

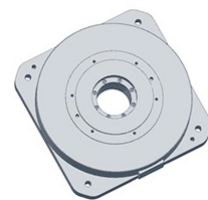

MAIN PARAMETERS	FE-22442	FE-22462
Voltage(VAC)	220	220
Rated torque (Nm)	14.1	35.0
Instant Max Torque (Nm)	42.2	105
Torque constant (Nm/Arms)	6.4	15.7
Rated Current (Arms)	2.2	2.2
Instant Max Current (Arms)	6.6	6.6
Resistance (Ω)	7.5	13.8
Inductance (mH)	17.1	40
Pole-pairs number (2P)	20	20
Back EMF coefficient (Vrms/rad/s)	5.2	12.8
Rated Output (W)	295.5	366.8
Rotor inertia $10^{-4}kg.m^2$	120	300
Rated Speed (rpm)	200	100
Max Speed (rpm)	380	200
Positioning accuracy(arc_sec)	± 20	± 20
Repeat positioning accuracy (arc_sec)	± 1.5	± 1.5
Encoder resolution (sin/cos)	11740	16384
Axial load (N)	10000	10000
Radial load (N.m)	120	120
Axial runout (mm)	≤ 0.005	≤ 0.005
Radial runout (mm)	≤ 0.005	≤ 0.005
Weight (kg)	5.5	9.2
Motor height L(mm)	42	62

Specification & drawing

